

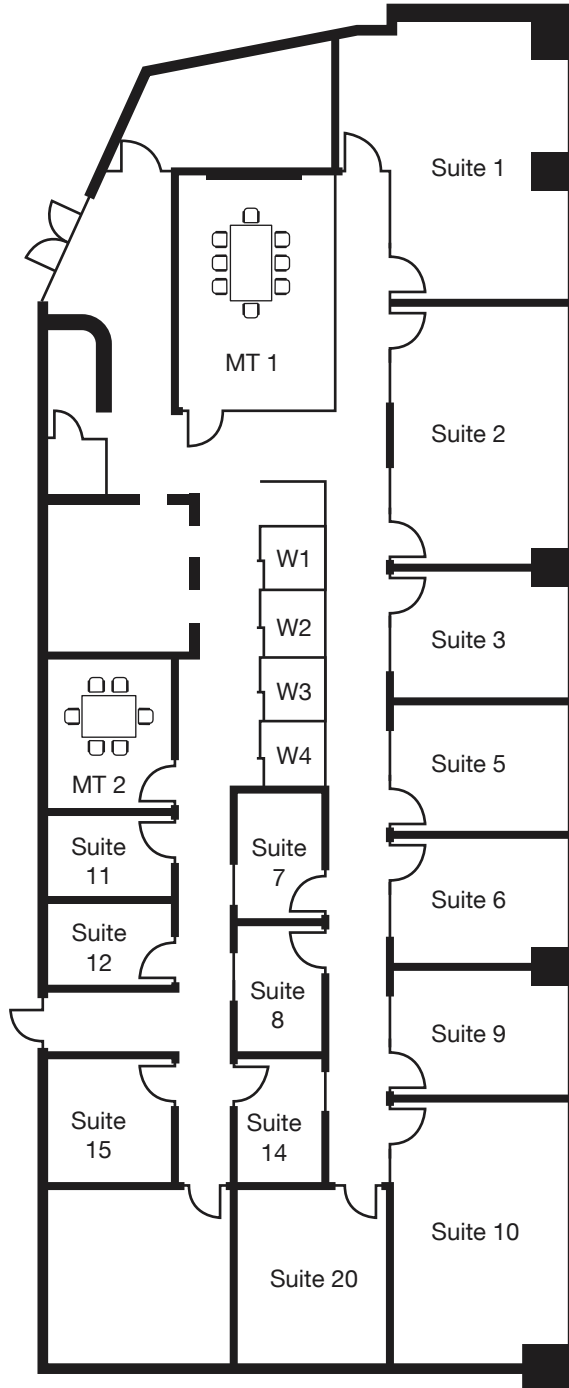

WORLD'S MOST
**ADVANCED
OFFICE**

Floor Plan



Total Area of the Office Suite

Suite 1 <i>Room with view</i>	28.1 m ²
Suite 2 <i>Room with view</i>	23.7 m ²
Suite 3 <i>Room with view</i>	11.7 m ²
Suite 5 <i>Room with view</i>	12.0 m ²
Suite 6 <i>Room with view</i>	11.7 m ²
Suite 7 <i>Room without view</i>	6.0 m ²
Suite 8 <i>Room without view</i>	6.0 m ²
Suite 9 <i>Room with view</i>	11.7 m ²
Suite 10 <i>Room with view</i>	23.7 m ²
Suite 11 <i>Room without view</i>	6.0 m ²
Suite 12 <i>Room without view</i>	6.0 m ²
Suite 14 <i>Room without view</i>	6.0 m ²
Suite 15 <i>Room without view</i>	9.0 m ²
Suite 20 <i>Room without view</i>	14.0 m ²

Facilities Included

Fully furnished brand new office.

Wireless Broadband Internet connection.

Free **coffee, tea, drinking water**.

Inclusive of all utilities bill.

Professional receptionist to manage all incoming call.

Dedicated local **telephone number**.

Dedicated local **fax number** with instant fax forwarding to your email.

Free outside business hours **voicemail to email service**.

kuala lumpur
malaysia
plaza mont kiara



selangor
malaysia
empire tower



jakarta
indonesia
menara rajawali
the city tower
office8



melbourne
australia
365 little collins



ho chi minh
vietnam
vietnam business
centre



hong kong
china
central tower



beijing
china
beijing yintai
centre



bangkok
thailand
empire tower



graha surveyor

“ For more information, please call +6221 29 222 999 or write to cs@vOffice.co.id ”